

Troubleshooting guide

If you have installed and connected the fitting as per the instructions listed earlier and it does not function correctly, use the following table as a guide to fixing the problem. Look up the type of fault in the left column and check the possible causes from the right column.

If the fitting still does not work after checking these possible causes, contact ABB customer service in Australia on 1800 60 20 20.

No.	Fault	Possible causes
1	Charge indicator LED not lit	AC supply not connected; or AC supply turned off; or Battery not connected
2	Charge indicator LED is lit but lamp indicator LED not lit and lamp does not come on when test switch is pressed	Lamp damaged; or Lamp not connected properly; or Battery pack damaged; or Test switch damaged
3	Lamp is lit momentarily when test switch is pressed; or When mains fail	Battery not fully charged; or Battery pack damaged
4	Emergency discharge duration time fail	Battery pack should be replaced when the luminaire no longer meets the discharge duration performance

ABB Australia Pty Limited

For enquiries
ABB contact centre: 1800 60 20 20
E-mail: AU-ABB-Stanilite@abb.com

INSTALLATION MANUAL

Stanilite® ECOFLOOD_V2 LED weatherproof Emergency Non-maintained

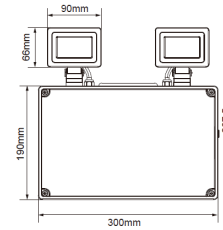

Thank you for choosing ABB product

Please read this document thoroughly before commencing installation and retain for future reference. Contact ABB customer service in Australia on 1800 60 20 20 if you need any assistance. The installation instructions were correct at the time of print. To reflect changes in technology and Australian standards; ABB reserves the right to amend the instructions without notice. Updated document can be found on the Stanilite website.

Safety warning

In Australia and New Zealand, only licensed electricians are permitted by law to work with 240 volt electrical installations. Do not attempt to install or connect this product unless you are a licensed electrician. Turn off and isolate the electrical supply before connecting this fitting to the building wires. Do not touch the terminals of the terminal block when the light fitting is energised. The only user-serviceable part is the battery. Do not attempt to service other parts of the fitting as this will void the warranty. As the installer, it is your responsibility to ensure compliance with all relevant building and safety codes, (ie: AS/NZS 3000, AS/NZS 2293). Refer to the applicable standards for data and mains cabling installation procedures and requirements.

This document covers	What's inside the box
Safety warning	ECOFLOOD_V2 LED weatherproof
Installation instructions	LED lamps (2)
Removal instructions	Accessory kit
Testing precautions	Installation manual
Troubleshooting guide	Warranty information

Important to note:

- This product is designed for indoor and outdoor use.
- Not suitable for installations where exposure to direct sunlight may occur.

Installation instructions

1. Determine the mounting height and position, allow at least 100mm of clearance space on either side of the enclosure to ensure adequate operation space for the LED/push-button when the fitting is installed. Open the front cover 4 screws, using suitable size screwdriver. For mounting holes and mains cable entry position, see figure 1 below for more details.

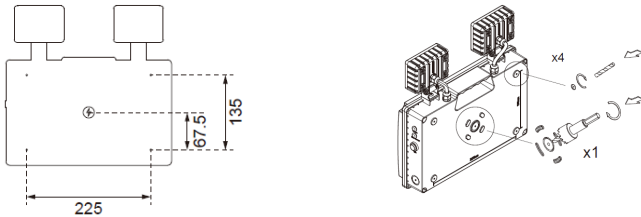

Figure 1: ECOFLOOD LED weatherproof mounting hole details and mains cable entry

2. Due to the wide variety of building construction materials, please use the appropriate fasteners for mounting, if the fasteners supplied are not suitable, depending on the installation/building construction. Make sure the mounting screws are fixed into solid material that is enough to support the weight of the fitting.

Installer must ensure proper sealing of any penetration to the base to maintain the rating of the luminaire

3. Run mains cable, slide the cable gland over the cable then feed the cable through the entry hole of the base. Allow adequate wire length to reach the terminal block then secure the cable gland in place. Terminate mains wires to the terminal block. Be careful with multi-strand conductors, ensure that all the strands are twisted together before insertion into the terminal block.

4. Verify that the battery is connected. Connect the battery plug to PCA if not connected before securing the front cover to the base.

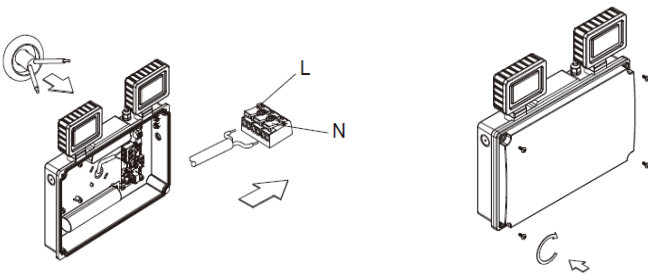

Figure 2: Showing internal layout and battery

5. Adjust the lamp head position, depending on the mounting height and area to be covered for optimum coverage, avoid excessive lamp head tilt which may cause overshadow. Make sure there is no overshadow.

6. Check operation of the fitting to ensure that the installation was successful. When powered up, allow a few minutes to give the battery a small charge, then press the manual test button located at the top right-hand side of the fitting. Hold the test button in for a few seconds and observe operation of the luminaire switching from mains to the emergency mode. If the lamp on emergency mode works momentarily, that's okay. Try again in a few more minutes in case battery is completely discharged, it may take a little time to charge up enough to operate even momentarily. After this time, press the test button again and if the lamp does not work at all, check the supply, the connections and the troubleshooting guide at the end of this document.

Important: 24 hours is required to allow the fitting battery to reach full capacity, ie: prior to a discharge test. As the installer, it is your responsibility to conduct the initial discharge testing of the installed fitting. Refer to AS/NZS 2293.

Removal instructions

1. Before removing the installed fitting, switch off the mains supply to the fitting.
2. Remove the cover/lid, disconnect the mains cable connection from the terminal block and battery plug from PCBA.
3. Undo the mounting screws and remove the fitting from wall.

Testing precautions

Once the fitting is permanently connected to the mains supply, a commissioning discharge test as required in AS/NZS 2293.2 must be carried out.

You will need to allow 24 hours for the battery to fully charge prior to conducting this test, presently (at the time of writing), the standard requires that fittings operate in emergency mode for a period not less than 2 hours for their commissioning test and for not less than 90 minutes thereafter (it is required that 6 monthly discharge tests be carried out). You will need to keep the records for the commissioning test and enter them into the building emergency services logbook or via other recording methods as allowed by AS/NZS 2293.2.

Construction sites

Continuously switching off the mains power supply that is connected to emergency light fittings during the construction phase of an installation will cause these fittings to discharge and charge their batteries many times over a short period; this can shorten life of the battery. ABB does not recommend such practices and may not honour the warranty on batteries when they are subjected to such harsh operating conditions. Emergency light fittings are designed to be discharge tested once every 6 months as per AS/NZS 2293.2, subjecting the product to repeated discharge or charge cycles is regarded as an abuse of the fittings.