

INSTALLATION INSTRUCTIONS MOULDED CASE CIRCUIT BREAKERS TEMBREAK PRO P250 4P SMART ELECTRONIC

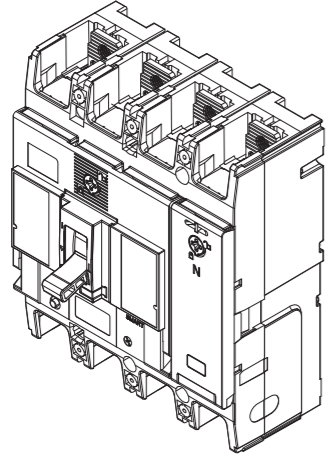

NHP Electrical Engineering Products Pty Ltd
A.B.N. 84 004 304 812
AUS 1300 NHP NHP | nhp.com.au
NZ 0800 NHP NHP | nhp-nz.com

TOOLS REQUIRED (NOT included)

- T1 Screwdriver Flathead (5mm)
- T2 Screwdriver Phillips (#2)
- T3 17mm Socket wrench
- T4 6mm Allen key Socket wrench
- T5 17mm Ring Spanner

HARDWARE (included)

- A M8x20 Socket screw (8 qty)
- B M8 spring washer (8 qty)
- C M8 flat washer (8 qty)
- D M4x55 mounting screws (2 qty)
- E Interpole Barriers (3 qty)
- Instruction Manual (This Document) (1 qty)

HARDWARE (NOT included)

- F Lugs or Copper Bars
- G *M10x25 hex bolt (8 qty)
- H *M10 flat washer (8 qty)
- I *M10 Belleville washer (8 qty)
- J *M10 nut (8 qty)

*For extension bar connection only

OPTIONAL (NOT included)

- K Extension Bars
- L Terminal Covers
- M Terminal Cover Lock
- N Handle Lock
- Internal Accessories

MOUNTING ANGLES

MOUNTING

TORQUE
1.3-1.7 Nm

DIMENSIONS

CLEARANCE

BR₁, BR₂ = Adjacent Isolators / MCCBs

MCCB Cat No.	Y min (mm)	Z min (mm)
P250F	0	25
P250N	0	25
P250H	0	25

CLEARANCE

INSULATION PLATE
TOP PLATE (EARTHED METAL)

BR₁, BR₂ = Adjacent MCCBs

*distance from conductor insulation to downstream MCCB

MCCB Cat No.	W* min (mm)	X ₁ min (mm)	X ₂ min (mm)
P250F	50	40	30
P250N	80	80	30
P250H	80	80	30

OPERATING INSTRUCTIONS

I (ON)
O (OFF)
TRIP
RESET
TRIPPED

Operation	Force (Nm)
OFF → ON	55
ON → OFF	40
TRIP → OFF	65

DIRECTION OF POWER SUPPLY

INTERNAL ACCESSORIES ASSEMBLY PROCEDURE*

STEP 1 TRIP MCCB

STEP 2 OPEN COVER

STEP 3 IDENTIFY TRIP BAR & MECHANISM

STEP 4 UVT/SHUNT INSTALLATION

4.1 UVT/SHUNT

4.2 ALARM

STEP 5 CLOSE MCCB COVER

*For additional internal accessory installations, scan QR code and refer to user manual for more details

SMART AXIAL INSTALLATION PROCEDURE

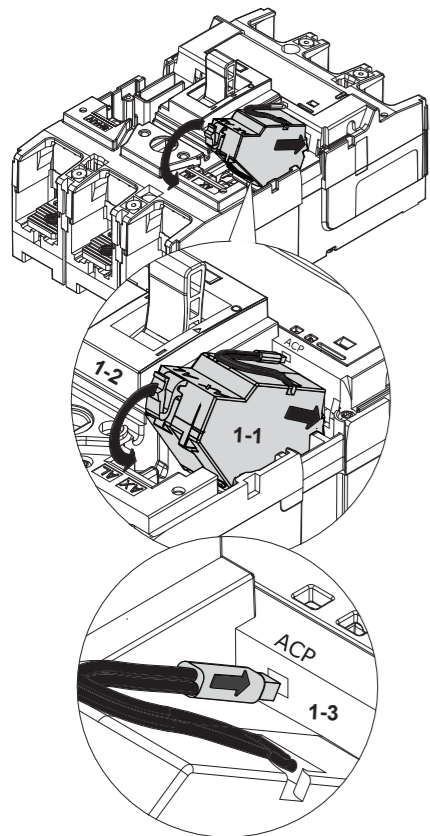

NOTE: SMART type AXIAL can only be installed in the LH side accessories chamber as shown above.

Follow steps 1,2 and 5 of 'Internal Accessories Mounting Procedure' to access and close the internal accessories chambers.

CONDUCTOR CONNECTION PROCEDURE -- FRONT CONNECTION -- EXTENSION BAR CONNECTION PROCEDURE

A	M8x20 Socket screw	F	Lug or copper bar	I	M10 Belleville washer
B	M8 Spring washer	G	M10x25 hex bolt	J	M10 Nut
C	M8 Flat washer	H	M10 Flat washer	K	Extension Bar

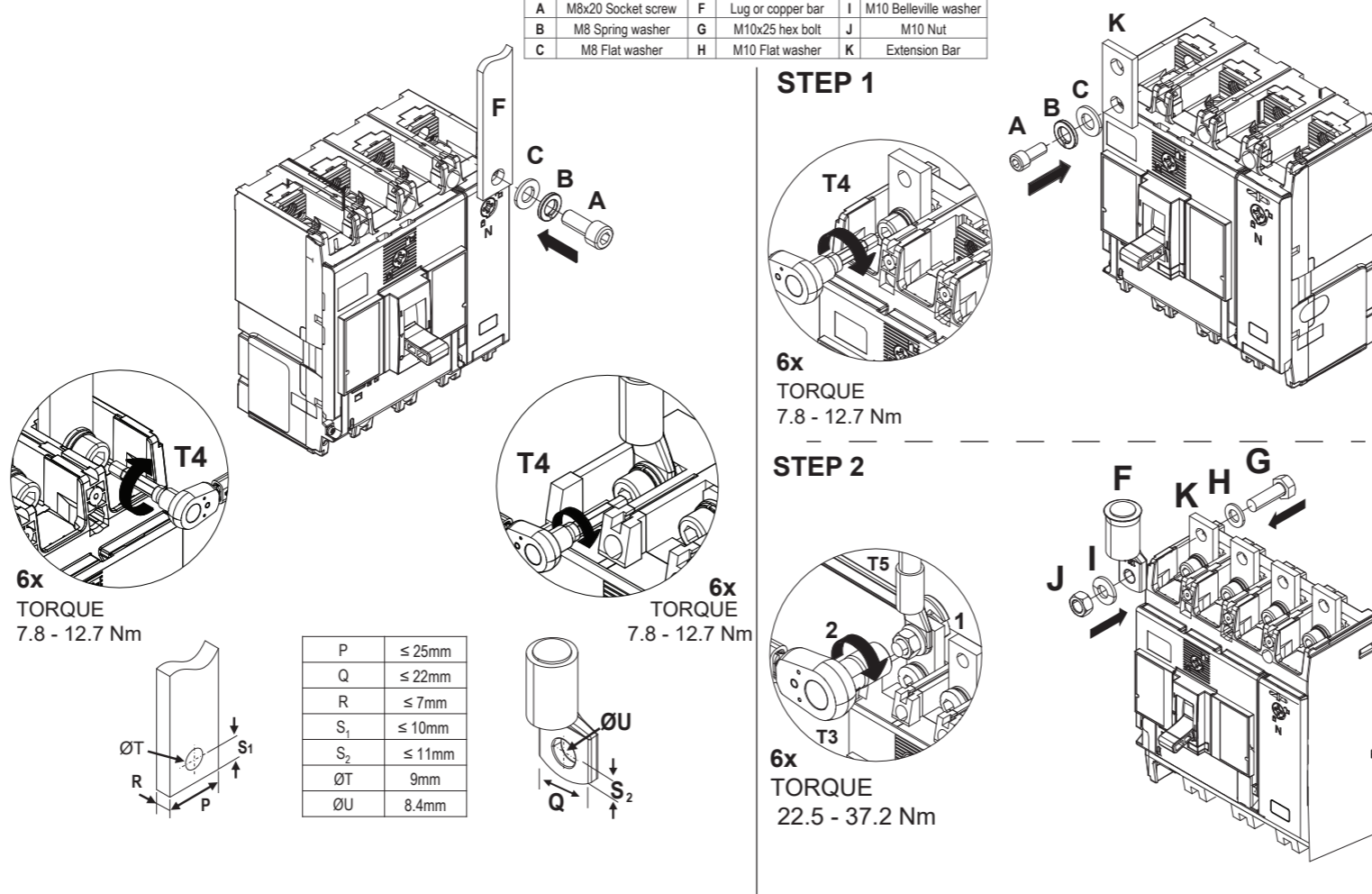

TRIP UNIT ADJUSTMENT PROCEDURE

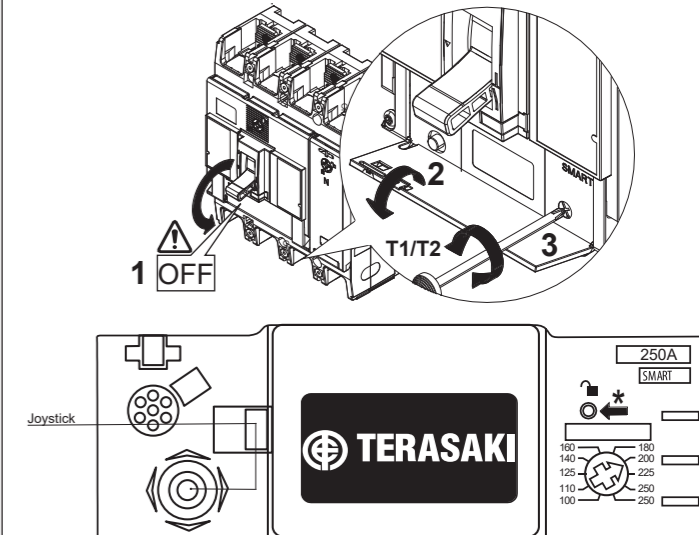

- NAVIGATION
- Adjust 'Ir' dial for desired rated current
 - To navigate between main menus, move joystick left or right
 - To navigate within a submenu, move joystick up or down
 - To confirm a setting change, press in the joystick

Protection	Measurement	Configuration	Information
DISPLAY ORIENTATION	STANDBY MODE	SCREEN BRIGHTNESS	

*by default, the SMART OCR Protection settings are protected via a locking function, to unlock, please press the unlock button

FOR MORE INFORMATION, PLEASE SCAN THE QR CODE

TERMINAL COVER

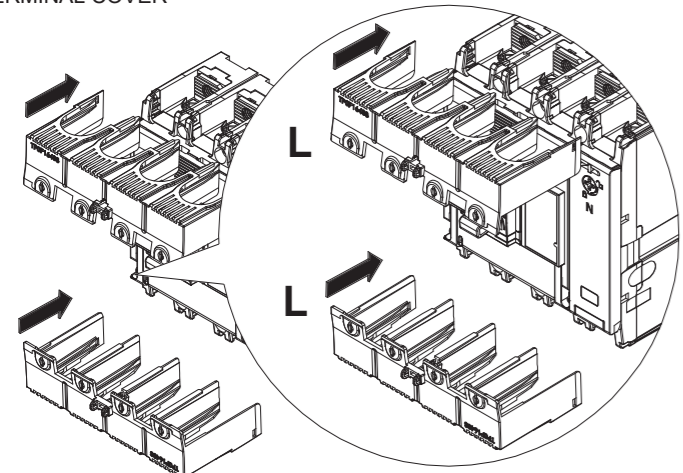

OR

INTERPOLE BARRIER

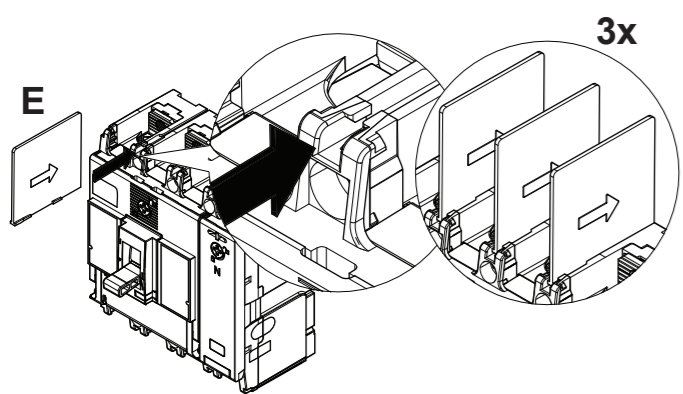

TERMINAL COVER LOCK

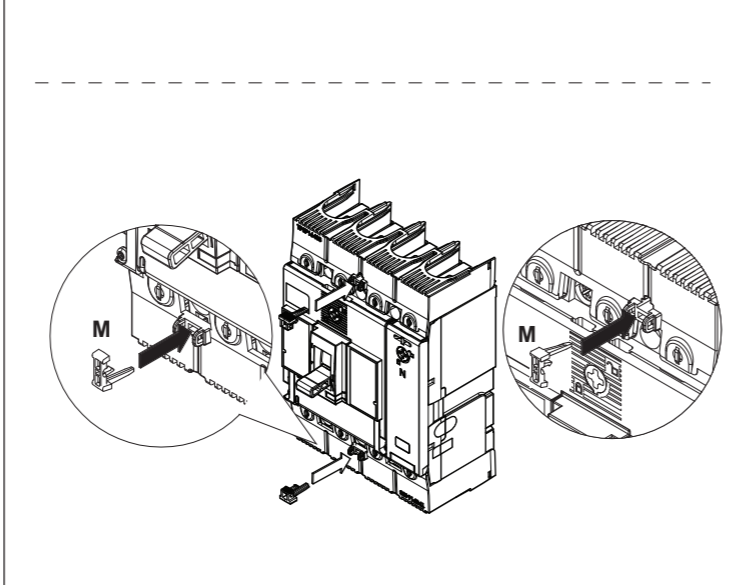
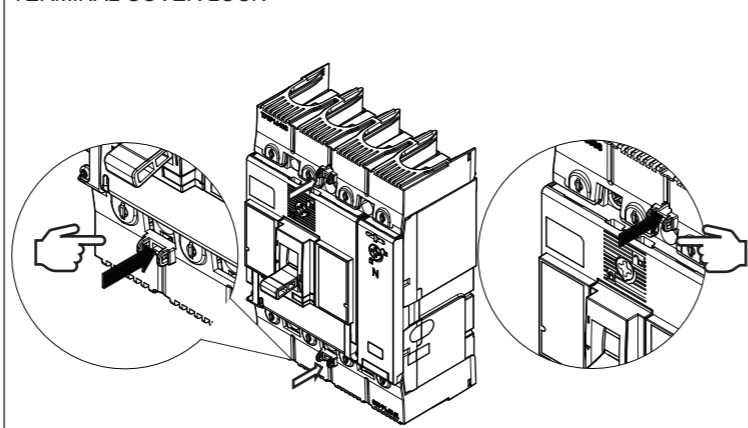

TOGGLE LOCK / PADLOCK ASSEMBLY PROCEDURE

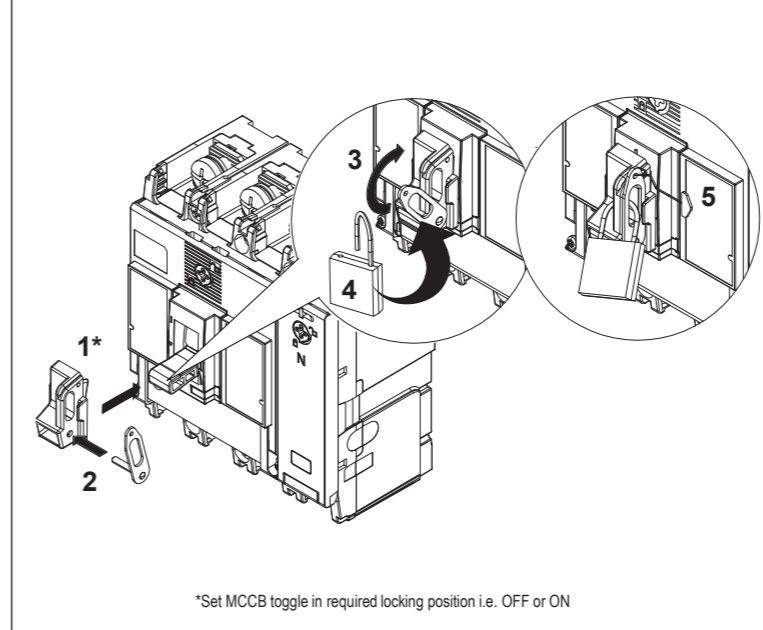

TOGGLE LOCK OPTION

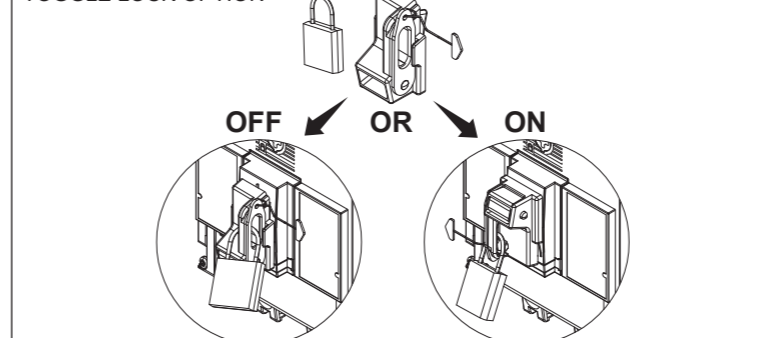

TIME CURRENT CHARACTERISTIC CURVE

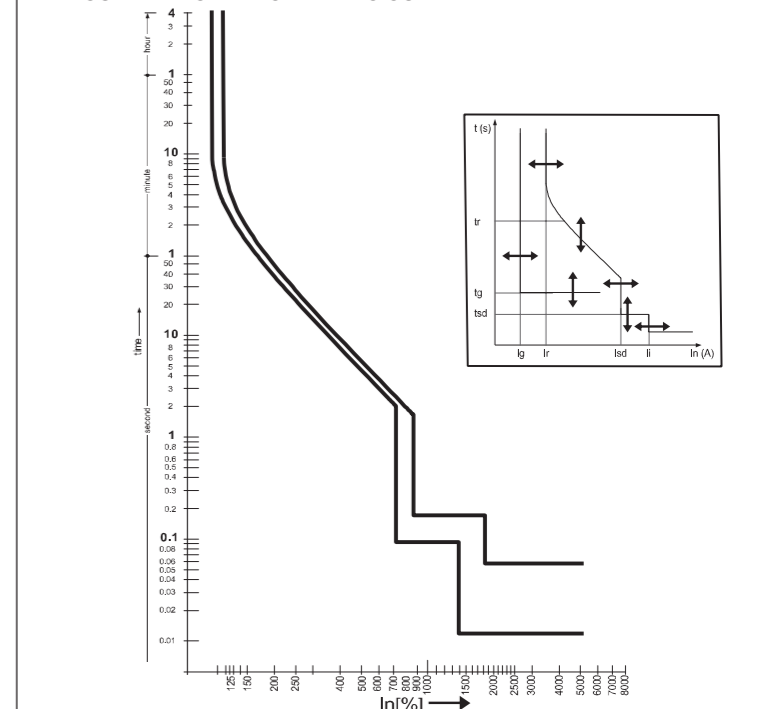

	Threshold Adjustment	Time Setting
Long-time protection	(Ir)	(tr)
Short-time protection	(Isd)	(tsd) (I't)
Instant protection	(li)	
Protecting Earth	(lg)	(tg) (I't)
Neutral protection	(N)	

NOTE: The protection menu consists of sub-menus to view and edit each OCR protection setting